

# LED SPOT Emer Dali SE 3W Autotest

**Relco**  
1967

707/25 - 1/2  
Importato da Relco S.r.l.  
Via delle Azalee, 6/A  
20090 - Buccinasco (MI) - Italy

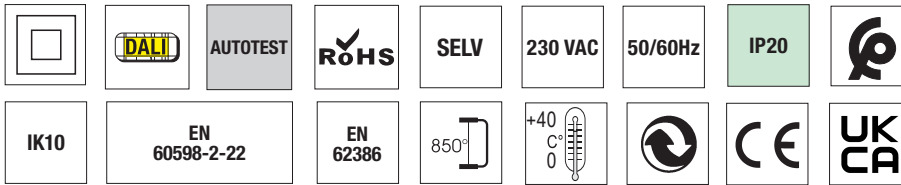

È vietato lo smaltimento come rifiuto urbano è obbligatoria la raccolta separata a fine vita del prodotto  
"Consorzio di appartenenza RAEE: Ecolight."  
Registro Nazionale dei Produttori N°: IT08020000000670

## Feature

- Supply Voltage: 220-240VAC 50/60Hz
- Insulation Class: II
- Ingress Protection: IP20
- Battery Recharge Time: 24h (EU)/16h (AU)
- Max Battery Temperature: 60°C
- Ambient Temperature: 5-40°C
- Charge indicator: Green LED
- Deep Discharge Protection DDP
- Assembly indoors to flat surface
- Non-maintained Operation
- The lamp holder shall not be replaced

## Important

It is recommended that the unit is installed by a competent person ensuring the installation complies with the necessary standards. The company accept no responsibility for incorrect installation, operation or maintenance. After installation of the fitting, the battery must be charged for 16/24 hours.

## Description

Item code	Batteries	EM power	EM Duration	Lumens	Charge Current	Charge Time	Lens
8550RELD	3.2V 3000mAh LiFePO4	3W	3h	250	200mA±10%	24h	Open Area
				185			Corridor

The assembly instruction must be given to end users for correct maintenance and so that they know how to change the bulb. The appliance must not be tempered with or transformed and it must be installed and used as supplied and in compliance with the National Rules on Installation. Any non-compliant installations will invalidate all form of guarantee. The company cannot be held responsible for damage caused by incorrect assembly.

Appliance safety is guaranteed only observing these instructions, both for installation and use. They must be preserved. The manufacturer will not respond to damage deriving from incorrect use of the appliance. After having removed the packaging, check the integrity of the appliance. The packaging elements (plastic bags, expanded polystyrene, staples) must not be left in children's reach, as they are potential sources of danger. Do not use the appliance if damaged. This appliance is destined solely for the use for which it was expressly intended. The manufacturer cannot be held responsible for damage deriving from improper or incorrect use of the distribution network.

### - Installation must only be carried out by trained personnel.

- Disconnect the power supply before carrying out any operation
- Do not power the device with a voltage higher than that shown on the mark.
- The fitting is suitable for installation on no-combustible surface.
- Do not apply on surface which can be damaged by heat.

**Warning:** The safety of the fitting is only guaranteed with the appropriate use of the following instructions.

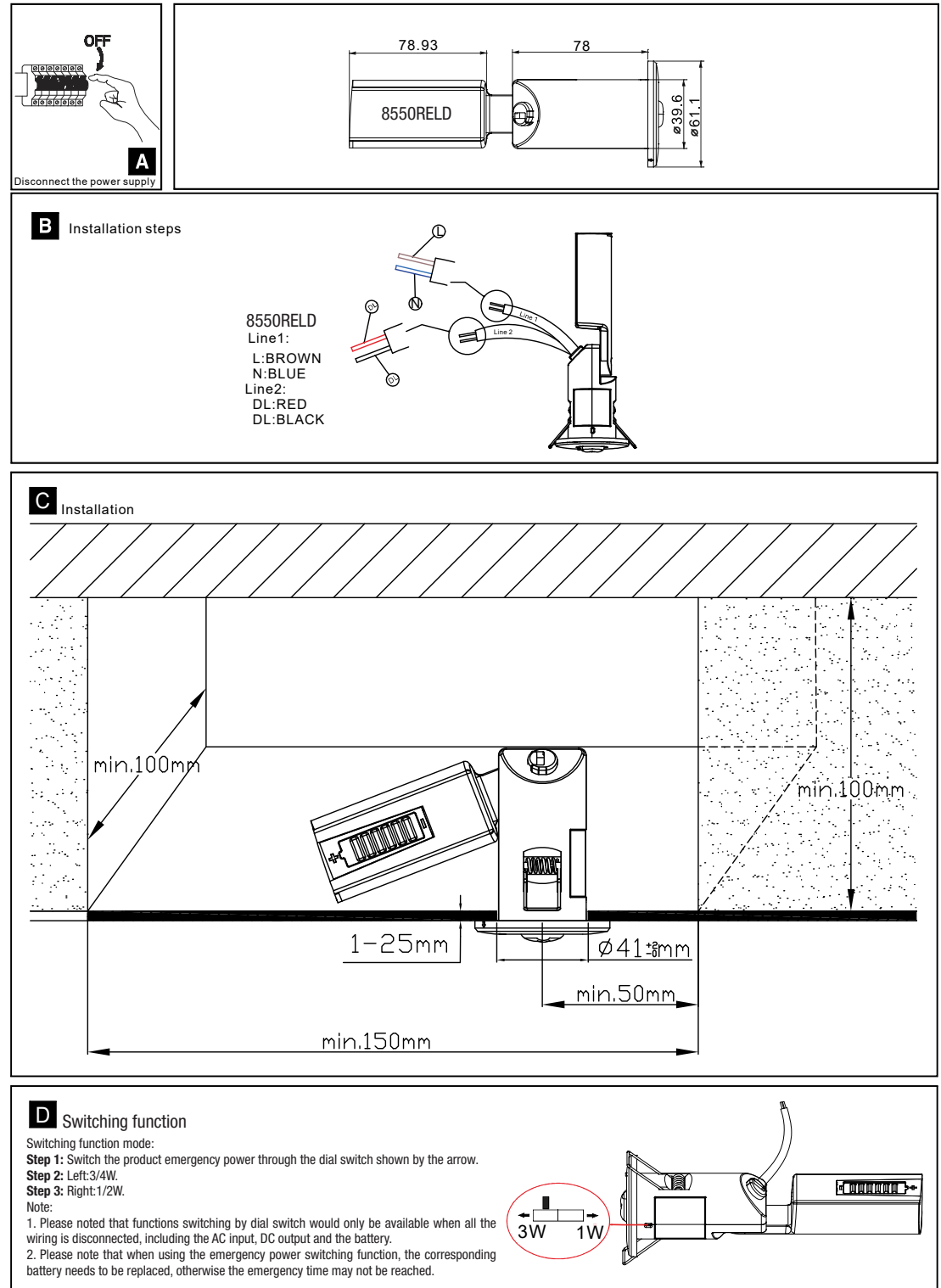

## E Replace the lens

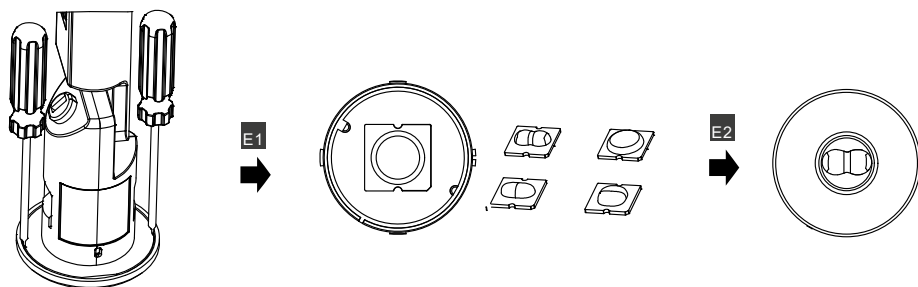

## F Battery replacement

18650 LiFePO4 3.2V 3000mAh

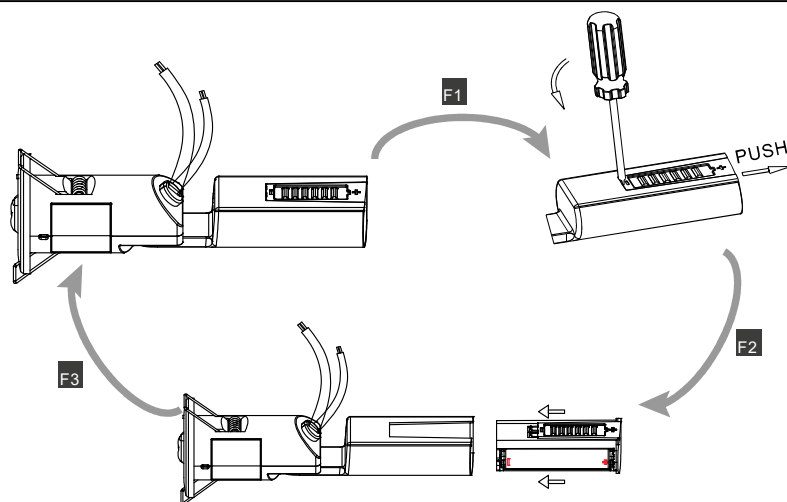

## Important notes!

All maintenance, such as changing the batteries or light source on this luminaire, should only be performed by professionals. Before maintenance, please disconnect all power sources.

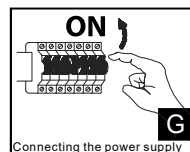

## H Important

- The electric source for safety service is not a user serviceable item and shall only be replaced by the manufacturer service agent or a similar qualified person. The company accept no responsibility for incorrect installation, incorrect operation or improper maintenance. After installation of the fitting, the battery must be charged for 16/24 hours for duration test.
  - Battery should be charged every three months in order to keep it's initial performance.
- When the lamp reaches the rated life, the whole lamp needs to be replaced. The drawing in the fitting may vary to the actual product, connect as per label on fitting. When fitting a flush fitting, refer to installation instruction, including any ceiling manufacturer's instructions.
- The drawing in the fitting may vary to the actual product, connect as per label on fitting.
- The recharging device will recharge the battery ESSS normally after removal the short circuit link and reconnecting the ESSS.
- Double or reinforce insulation between supply and battery/ESS circuits and based on a working voltage of 250V;

## LED SPOT Emer Dali SE 3W Autotest

**Relco**  
1967

707/25 - 2/2  
Importato da Relco S.r.l.  
Via delle Azalee, 6/A  
20090 - Buccinasco (MI) - Italy

### Testing/Commissioning (DALI)

**8550RELD** DALI series comfort IEC62386-102 and IEC 62386-202(DT1) standard protocol. It is perfectly compatible with DALI control system of Tridonic, Osram, Philips and other famous international brands.

1. With a variety of working mode switching functions: normal mode, emergency mode, rest mode, inhibit mode function test mode and duration test mode.
2. Functional test time interval and duration test time interval can be set and read to achieve automatic test function.
3. Automatic recording and reading of 8550RELD series working time and emergency time
4. Various normal and emergency status reads.

### DALI Control

1. A DALI command from a suitable control unit can be used to initiate function and duration tests at individually selected times Status flags are set for report back and data logging of results.
2. When a DALI bus has not been connected or when a DALI bus is connected but the DALI default DELAY and INTERVAL times have not been re-set by sending appropriate DALI commands, then the 8550RELD will conduct self-tests in accordance with the default times set within the 8550RELD
3. These default times are factory pre-set, in accordance with the DALI standard EN 62386-202. to conduct an automatic function test every 7 days and a duration test every 180 days. Since the DELAY time is factory pre-set to Zero, all units are tested at the same time. Test times can be changed with a command over the DALI bus.

### Indicator LED System status is locally by a bi-color indicator LED.

Led indication	Status	Description
Permanent Green	Standby ,System OK	Mains Operation battery is charged
Fast flashing Green (0.25s on 0.25s off)	Function test underway	Function test underway
Slow flashing Green (1s on 1s off)	Duration test underway	Duration test underway
Permanent Red	Lamp failure	Open Circuit or Short circuit or LED failure
Fast flashing Red (0.25s on 0.25s off)	Battery capacity failure	Battery failed duration test
Slow flashing Red (1s on 1s off)	Battery fault	Incorrect battery voltage or Short circuit or Open Circuit
Green and Red off	Battery Operation	Emergency mode: Mains disconnected or Mains failure
Slow flashing Red (1s on 3s off)	Battery temperature error	When power on and battery temperature is above 55(+2)°C or below 0(+2)°C

### NOTICE

Fault status:

If an error is detected the indicator LED switches to RED. If the error has been corrected please re-connecting the battery after the mains power off, the indicator LED immediately switches back to GREEN when mains power on.

### NOTICE

Battery failed duration test:

After an exchange of the battery and holding down the button (>10S) reset the timer, the indicator LED switches to GREEN.

### NOTICE

When it is detected that the battery capacity is insufficient, power off and unplug the battery and power on again, which can be reset.

### Additional guidelines

Ensure correct polarity of the battery

The drawing in the fitting may vary to the actual product, connect as per label on fitting.

When fitting a flush fitting, refer to installation instruction, including any ceiling manufacturer's instructions.

### Remark:

- The battery should be changed when the battery be failed on charging's ability.
- The LED's module from the light is non-replaceable.
- Building insulation may about the sides of the luminaire.

**Relco**  
1967