

RELCO 8550RELD DALI series - recessed spot emergency lights

Feature

- Supply Voltage:220-240VAC 50/60Hz
- Insulation Class: II
- Ingress Protection:IP20
- Battery Recharge Time: 24h(EU)/16h(AU)
- Max Battery Temperature:60°C
- Ambient Temperature:0-40°C
- Charge indicator:Green LED
- Deep Discharge Protection DDP
- Assembly indoors to flat surface
- Non-maintained Operation
- The lamp holder shall not be replaced

Important:

It is recommended that the unit is installed by a competent person ensuring the installation complies with the necessary standards. The company accept no responsibility for incorrect installation, operation or maintenance. After installation of the fitting, the battery must be charged for 16/24 hours.

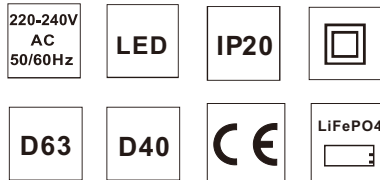

Description

Item Code	Batteries	EM Power	EM Duration	Lumens	Charge Current	Charge Time	Mode	Classification
8550RELD	LiFePO4 3.2V 3000mAh	3W	3h	250lm	200mA±10%	24h	Open Area	/

Dimensions

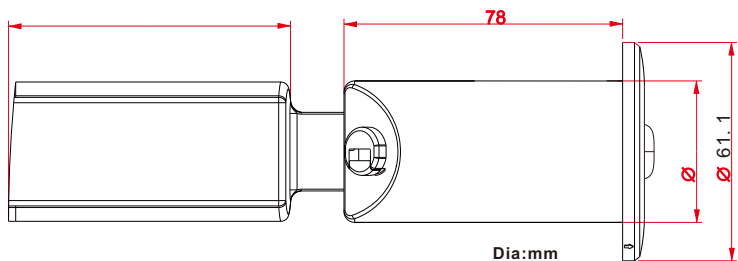

Connections

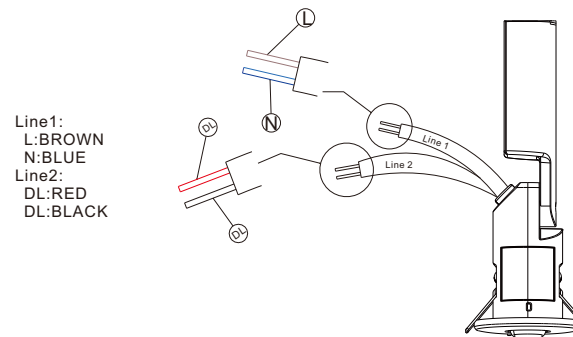

Mounting Options

Battery replacement steps
Step 1: Plug the battery into the product

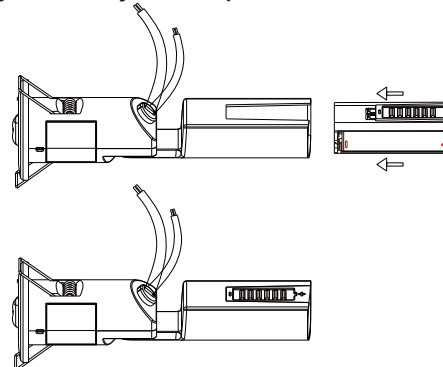

Replacement battery: Push the battery out with a screwdriver

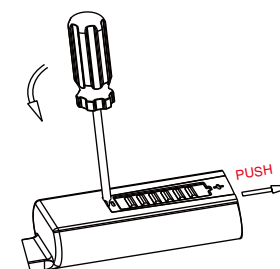

RELCO 8550RELD DALI series - recessed spot emergency lights

Step 2:wiring

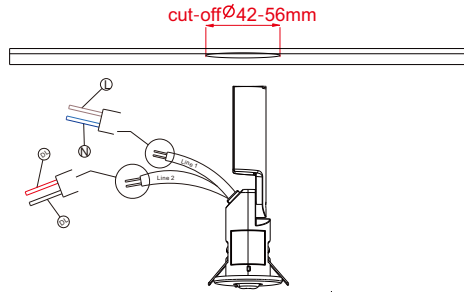

Step 3:Install the product on the ceiling.First, smash the spring up and stuff the product into the hole.

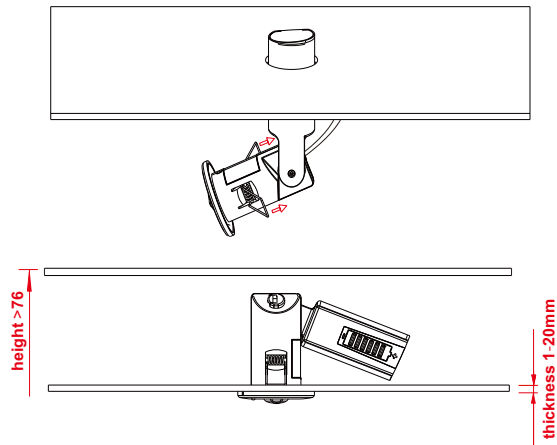

Attention: replace the lens

- Step 1:Use a screwdriver to pry open the cover
- Step 2:Remove the cover and change the lens.
- Step 3:Put back the cover

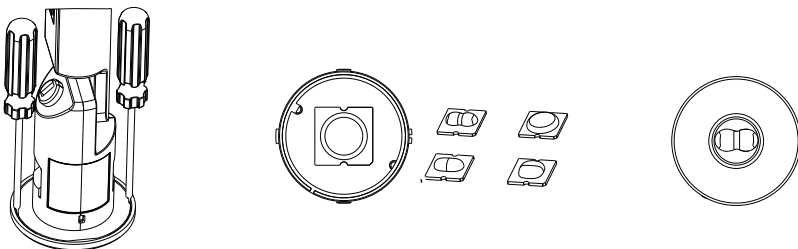

Testing/Commissioning(DALI)

8550RELD DALI series comfort IEC62386-102 and IEC 62386-202(DT1) standard protocol. It is perfectly compatible with DALI control system of Tridonic , Osram, Philips and other famous international brands.

1. With a variety of working mode switching functions : normal mode , emergency mode , rest mode , inhibit mode , function test mode and duration test mode.
2. Functional test time interval and duration test time interval can be set and read to achieve automatic test function.
3. Automatic recording and reading of 8550RELD series working time and emergency time
4. Various normal and emergency status reads

DALI Control

- 1.A DALI command from a suitable control unit can be used to initiate function and duration tests at individually selected times Status flags are set for report back and data logging of results.
2. When a DALI bus has not been connected or when a DALI bus is connected but the DALI default DELAY and INTERVAL times have not been re-set by sending appropriate DALI commands, then the 8550RELD will conduct self-tests in accordance with the default times set within the 8550RELD
3. These default times are factory pre-set, in accordance with the DALI standard EN 62386-202. to conduct an automatic function test every 7 days and a duration test every 180 days . Since the DELAY time is factory pre-set to Zero , all units are tested at the same time . Test times can be changed with a command over the DALI bus.

Indicator LED System status is locally by a bi-color indicator LED.

LED Indication	Status	Description
Permanent Green	Standby ,System OK	Mains Operation, battery is charged
Fast flashing Green (0.25s on 0.25s off)	Function test underway	Function test underway
Slow flashing Green (1s on 1s off)	Duration test underway	Duration test underway
Permanent Red	Lamp failure	Open Circuit or Short circuit or LED failure
Fast flashing Red (0.25s on 0.25s off)	Battery capacity failure	Battery failed duration test
Slow flashing Red (1s on 1s off)	Battery fault	Incorrect battery voltage or Short circuit or Open Circuit
Green and Red off	Battery Operation	Emergency mode:Mains disconnected or Mains failure

NOTICE

Fault status:

If an error is detected, the indicator LED switches to RED. If the error has been corrected please re-connecting the battery after the mains power off, the indicator LED immediately switches back to GREEN when mains power on.

Additional guidelines

Ensure correct polarity of the battery
The drawing in the fitting may vary to the actual product, connect as per label on fitting.
When fitting a flush fitting, refer to installation instruction, including any ceiling manufacturer's instructions.

Remark:

- The battery should be changed when the battery be failed on charging's ability
- The LED's module from the light is non-replaceable
- Building insulation may abut the sides of the luminaire