

DALI-2 PIR Motion Sensor**1. Technical Specifications**

Sensor Model	PIR detection
HIR23/D2/R	Installation Height : 6m Detection Range(Ø) : 10m
Lux reading range	< 1000 lux
Detection angle	360°
Operating voltage	9.5 ~ 22.5VDC
Consumption DALI BUS current	Max. 10 mA(no LED) Max. 12 mA(with LED)
Identify device	Red LED flashes 15S
Warming-up	5s
Operation temperature	Ta: -20°C ~ +50°C
IP rating	IP20

2. Installation

Wire Preparation

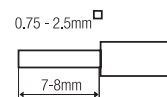

Pluggable screw terminal. It is recommended to make connections to the terminal before fitting to the sensor.

1. 200 metres (total) max. for 1mm² CSA (Ta = 50 °C)
2. 300 metres (total) max. for 1.5mm² CSA (Ta = 50 °C)

Mechanical Structure & Dimensions

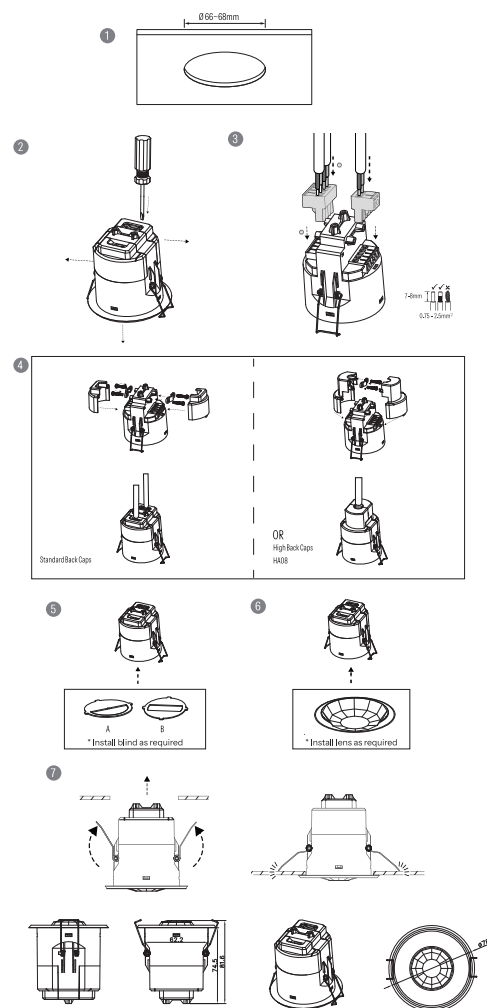

1. Ceiling (drill hole $\phi 66-68\text{mm}$)
2. Carefully prise off the cable clamps.
3. Make connections to the pluggable terminal blocks.
4. Insert plug connectors and secure using the provided cable clamps, then clip terminal covers to the base (provide high back caps HA08 option).
5. Fit detection blind (if required) and desired lens.
6. Clip fascia to body.
7. Bend back springs and insert into ceiling.

Wiring Diagram

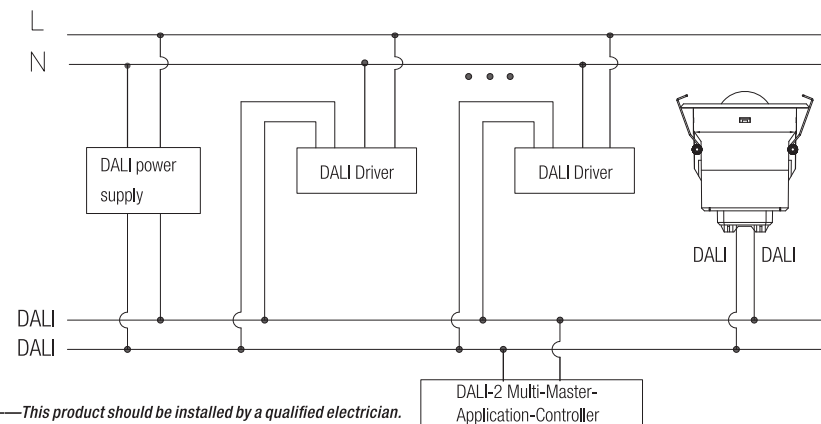

— This product should be installed by a qualified electrician.

Note: HIR23/D2/R has been used as DALI-2 input device to only report DALI instance (light sensor instance and motion sensor instance) to DALI-2 application controller, who is the "main brain" to process the data communication between input devices and the control gear and assign different function.

3. Detection Pattern & Optional Accessories

HIR23/D2/R (Reinforced Low-bay)



HIR23/D2/R: Low-bay convex lens detection pattern for **single person** @ Ta = 20°C
(Recommended ceiling mount installation height **2.5m-6m**)

A: Tangential movement	B: Radial movement	Mount height	Tangential (A)	Radial (B)
		2.5m	max 79m ² (Ø = 10m)	max 20m ² (Ø = 5m)
		3m	max 79m ² (Ø = 10m)	max 20m ² (Ø = 5m)
		4m	max 64m ² (Ø = 9m)	max 20m ² (Ø = 5m)
		5m	max 50m ² (Ø = 8m)	max 20m ² (Ø = 5m)
		6m	max 50m ² (Ø = 8m)	max 20m ² (Ø = 5m)

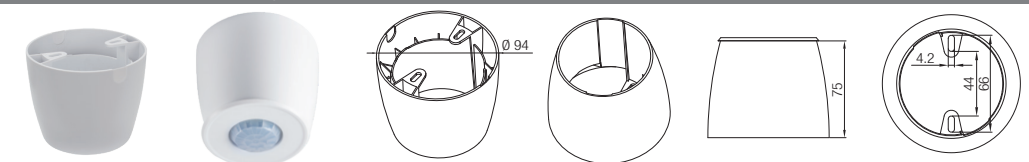
Optional Accessory --- Ceiling/Surface Mount Box: **HBTDAP**

Included Accessory --- Blind Insert for Blocking Certain Detection Angles

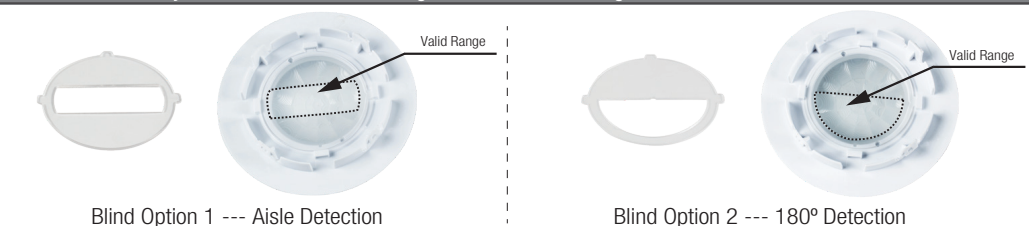

Blind Option 1 --- Aisle Detection

Blind Option 2 --- 180° Detection